

**YES, WE CHECK OUT iPADS:
IMPLEMENTATION AND DEPLOYMENT
OF iPADS IN ACADEMIC LIBRARIES**

**SLRLN
TECH EXPO
2015**

PRESENTERS

Fontbonne University

Julie Portman

Technical Services Librarian

jportman@fontbonne.edu

Rebecca van Kniest

Reference Librarian

rvankniest@fontbonne.edu

Logan University

Rick DeCaro

Director of IT

rick.decaro@logan.edu

Christina Prucha

Cataloger / Archivist

Christina.Prucha@logan.edu

UNIVERSITY BACKGROUND

	Logan	Fontbonne
FTE	926	1,383
Majors	Chiropractic, biology & life science, nutrition, sports rehab	Business, Education, Health, Liberal Arts
Physical holdings	45,767 (includes electronic resources)	123,354 (includes electronic resources)
Devices currently owned	10 – iPad	1 – Nook 2 – Nook Color 2 – Galaxy Tab 3 2 – Kindle Fire 3 – Kindle 2 – iPad Mini 8 – iPad Air

SETUP AND IMPLEMENTATION

Logan
University

WHY DID WE DECIDE TO LOAN IPADS?

- Logan recently implemented a new software package called ExamSoft for electronic test taking
 - For security reasons, iPads are the only supported mobile device.
- All incoming students are required to have an iPad
 - Cost of the iPad is part of student's financial aid
- Needed a way for students to borrow iPads for exams
 - Their iPad is not charged
 - Their iPad was left at home
 - LRC seemed like a good fit for loaning instead of IT
 - LRC is setup for checking in and out and has experience already with high cost items



HOW DID WE LOCK DOWN THE IPADS?

■ iPad Restrictions

- Created 4 digit code that only IT has access to
- Locked down everything except for access to ExamSoft and Safari
- Disabled ability to add accounts for email or messaging
- Disabled Messaging (After we had an issue)



RESTRICTION SETTINGS

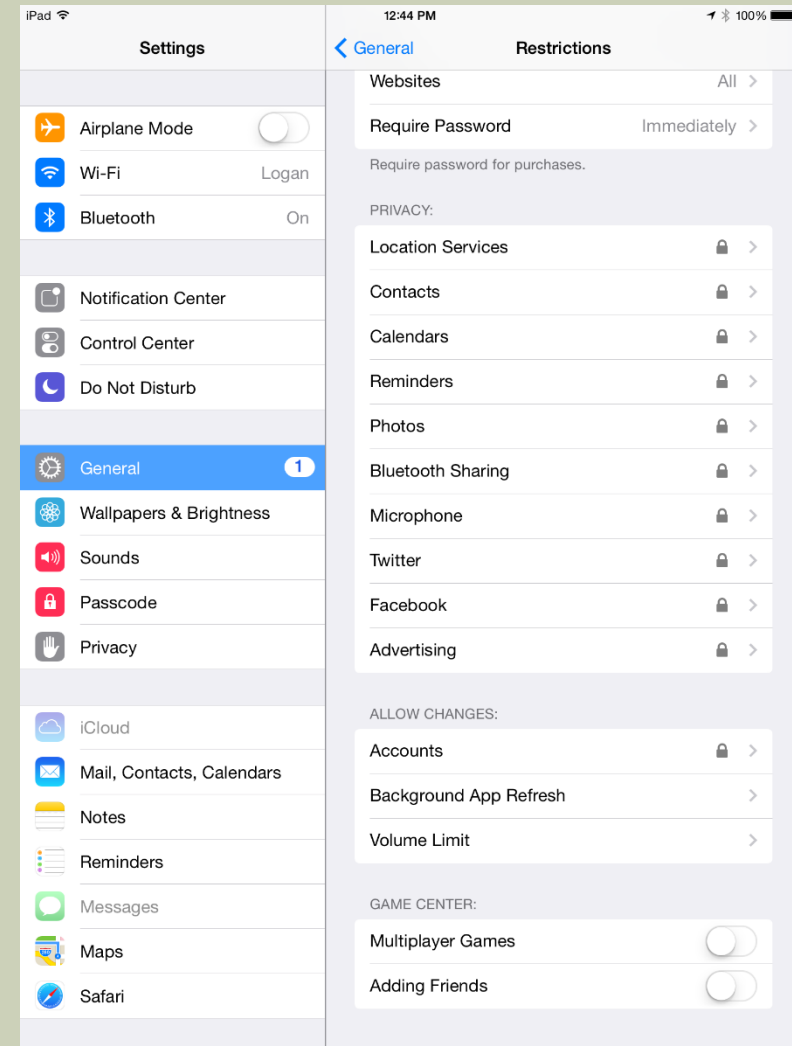

MOBILE DEVICE MANAGEMENT

- Used for tracking and App management.
- Features:
 - Remote Wipe
 - GPS Location
 - Device Status
 - Send Messages
 - Install Apps
 - Clear Passcode
- Cisco Meraki MDM is free



CISCO MERAKEI INTERFACE



rick.decaro@logan.edu | [3 new features](#)

Network: Tag:

New in Dashboard: [Color blind assist mode and 2 other features.](#) [Read more.](#)

- Monitor
 - Clients
 - Map
 - Remote desktop
 - Event log
 - Software
 - Command line
 - Summary
- MDM
- Configure
- Organization
- Help

Client list

Tag Location Move Delete Command Quarantine **10 matches in 102 clients**

<input type="checkbox"/>	#	Status	Name	Model ▲	Connected	Connectivity	User	Location	SSID	Disk % used	Tags	Managed?
<input type="checkbox"/>	1		LRC-Loaner10 iPad 221272	iPad Air	now		-	-	Logan	81%	LRC-Loaner	Yes
<input type="checkbox"/>	2		LRC-Loaner1 iPad 221268	iPad Air	now		-	-	Logan	95%	LRC-Loaner	Yes
<input type="checkbox"/>	3		LRC-Loaner3 iPad 221273	iPad Air	now		-	-	Logan	77%	LRC-Loaner	Yes
<input type="checkbox"/>	4		LRC-Loaner4 iPad 221275	iPad Air	now		-	-	Logan	49%	LRC-Loaner	Yes
<input type="checkbox"/>	5		LRC-Loaner5 iPad 221270	iPad Air	now		-	-	Logan	73%	LRC-Loaner	Yes
<input type="checkbox"/>	6		LRC-Loaner8 iPad 221265	iPad Air	now		-	-	Logan	47%	LRC-Loaner	Yes
<input type="checkbox"/>	7		LRC-Loaner9 iPad 221271	iPad Air	now		-	-	Logan	66%	LRC-Loaner	Yes
<input type="checkbox"/>	8		LRC-Loaner2 iPad 221267	iPad Air	Feb 15 20:17		-	-	Logan	38%	LRC-Loaner	Yes
<input type="checkbox"/>	9		LRC-Loaner6 iPad 221274	iPad Air	Feb 15 06:41		-	-	Logan	46%	LRC-Loaner	Yes
<input type="checkbox"/>	10		LRC-Loaner7 iPad 221264	iPad Air	Feb 14 10:24		-	-	Logan	54%	LRC-Loaner	Yes

DEVICE STATUS AND GPS LOCATION

Clients > **LRC-Loaner1_iPad_221268**

Client details | [Refresh details](#) | [Edit details](#)

Name: LRC-Loaner1_iPad_221268
Model: iPad Air
Serial: DLXN2EMSFK10
Warranty: [Apple](#)
Tags: [LRC-Loaner](#)
Auto tags: [iOS devices](#)
Charge: 100%
Owner: [Set an owner](#)

OS

Version: iOS 7.1.2

Security

Encryption: Both file-level and block-level capable
Passcode: Not present
Jailbroken?: No

Management

Settings: [up-to-date](#)
Apps: [up-to-date](#)
Supervised: No
Enrollment date: 12:01 Sep 3 2014

Storage

Device storage: 12.2 GB / 12.8 GB 96%

Network

LAN IP: 172.17.2.224
Public IP: 150.199.185.253
WiFi MAC: 80:E6:50:65:66:22
Bluetooth MAC: 80:E6:50:65:66:23

Online status

 | [Check-in now](#)

Last check-in: 13:41 Feb 23 2015

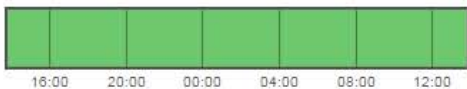

[Previous client in search](#) | [Next client in search](#)

Unknown location | [Refresh location](#)

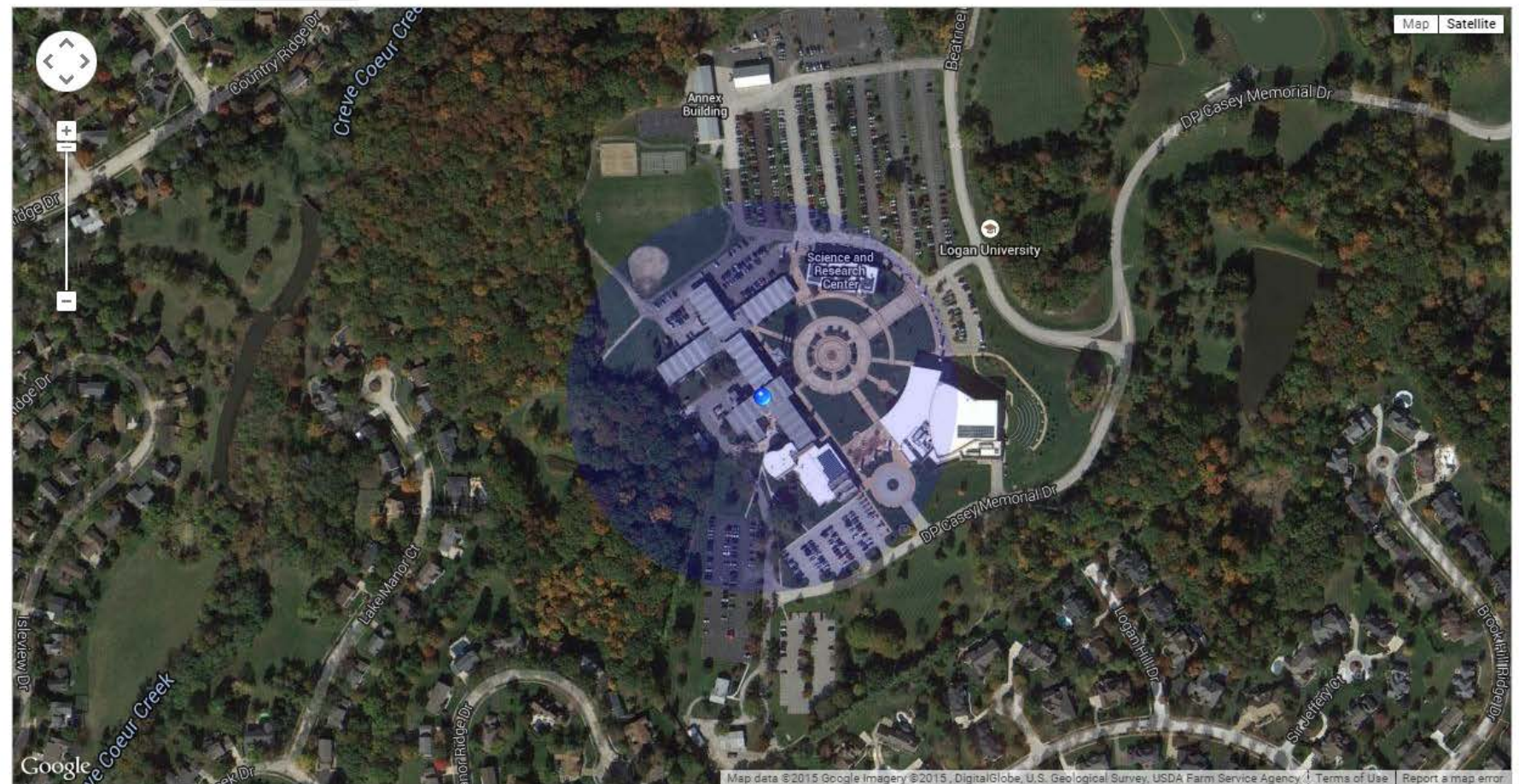

COMMANDS, APPS AND EVENT LOGS

MDM commands

Mobile security

AirPlay
Send notification
GPS location

Device security

Clear passcode	Lock device	Selective wipe	Erase device
----------------	-------------	----------------	--------------

Restrictions

Enforced by profile: **Meraki Management**

Force Encrypted Backup: Yes

Profiles

[Refresh profile list](#)

Installed ▾	Name	Managed?	Up-to-date?	Actions
Sep 03, 2014	LRC Loaner iPads	Yes	Yes	Reinstall
Sep 03, 2014	Meraki Management	-	-	-

Apps

[Refresh app list](#)

Search...

2 apps

Installed

Discover date ▾	Name	Vendor	Version	App size	App data	Managed?	Status	Actions
Sep 03, 2014	SofTestM	ExamSoft Worldwide, Inc.	014806	24.7 MB	16.6 MB	Yes	Installed	Update Remove
Sep 03, 2014	Meraki MDM	Meraki, Inc	3	5.0 MB	1.0 MB	Yes	Installed	Update Remove

Event log

Feb 22 13:48 CST to Feb 23 13:48 CST

Date ▾	Event type	User	Details
Feb 23 01:26	Retrieve restrictions response received	-	status:Acknowledged
Feb 23 01:26	List installed applications response received	-	status:Acknowledged
Feb 23 01:26	Retrieve security information response received	-	status:Acknowledged
Feb 23 01:26	List managed applications response received	-	status:Acknowledged
Feb 23 01:26	Retrieve device information response received	-	status:Acknowledged
Feb 23 01:26	Retrieve restrictions command enqueued	-	-
Feb 23 01:26	List installed applications command enqueued	-	-
Feb 23 01:26	Retrieve device information command enqueued	-	-
Feb 23 01:26	List managed applications command enqueued	-	-

DEVICE CLEANUP UPON RETURN

- Librarians are responsible for cleanup upon return of device
- 4 or 5 steps to reset device back to original configuration
- Easy because the devices are locked down so tight
 - Not necessary to wipe device each time it's checked back in



POLICIES AND PROCEDURES

**Logan
University**

LOGAN'S IPADS, THEIR USES, AND OUR USERS

- 10 iPads and chargers (8 and 30 pin w/ USB power adapter)
- Uses:
 - ExamSoft test software
 - attendance taking
 - test administration
 - Safari (internet)
 - messaging (until we disabled that)
- Users:
 - Faculty
 - Staff (no staff have taken advantage of this to my knowledge)
 - Students (Mostly used by students in trimesters testing with ExamSoft or those needing a cable)

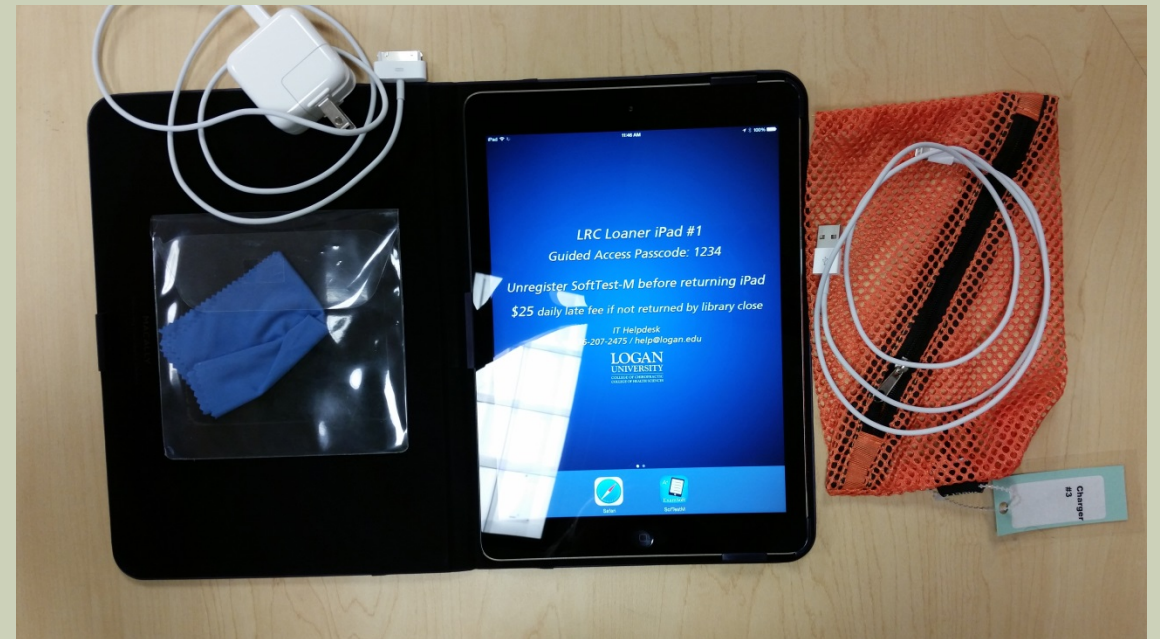

STORAGE AND CHARGING



IPAD AND CHARGER CATALOG RECORDS

iPad record in Sierra

Library Catalog [Logan] x 13 Bridges Library Catalog

bridges.searchmobius.org/record=b2280594-56

LOGAN UNIVERSITY
COLLEGE OF CHIROPRACTIC
COLLEGE OF HEALTH SCIENCES

BRIDGES
A MOBILUS Library Catalog

MOBILUS Bridges Logan University My Library Account Help Course Reserves

Request Add to My Lists Add to Bag MARC Display Search MOBILUS

RECORD NO b2280594 Logan Search

Limit search to available items

Title iPad Air [realia] / designed by Apple in California ; assembled in China.
Published Cupertino, Calif. : Apple, Inc., 2013.

Connect to
Fontbonne Tablet Policy

Copies	LOCATION	CALL NO	STATUS
	Logan iPads	iPad Air #8 c.10	AVAILABLE
	Logan iPads	iPad Air #8 c.8	AVAILABLE
	Logan iPads	iPad Air #9 c.9	AVAILABLE
	Logan iPads	iPad Air #7 c.7	AVAILABLE
	Logan iPads	iPad Air #4 c.4	AVAILABLE
	Logan iPads	iPad Air #5 c.5	AVAILABLE
	Logan iPads	iPad Air #2 c.2	AVAILABLE
	Logan iPads	iPad Air #3 c.3	AVAILABLE
	Logan iPads	iPad Air #6 c.6	AVAILABLE
	Logan iPads	iPad Air #1	AVAILABLE

Text item location

Permanent Link - <http://bridges.searchmobius.org/record=b2280594-56>

Description 1 tablet computer : black, sd., col. screen ; 24 x 17 x 1 cm. - lightning to USB cable (2 ft.) + 12W USB power adapter.
Note Model A0798LL/A ; adapter Model A1401; other Model no. A1474.
Supports Wi-Fi and Bluetooth.
Subjects iPad (Computer)
Tablet computers.
Other Author Apple Computer, Inc.
Other Title Apple iPad Air.
OCLC # 892223487

Concordia Seminary - Covenant Seminary - Fontbonne University - Harris-Stowe State University

iPad charger record in Sierra

Library Catalog [Logan] x 13 Bridges Library Catalog

bridges.searchmobius.org/search=567?xipad&searchscope=6&SORT=D?xipad&searchscope=6&SORT=D&SUBKEY=ipad1%2C3%2C5%2C6/frameset&FF=Xipad&searchscope=6&SORT=D&1%2C1%2C

LOGAN UNIVERSITY
COLLEGE OF CHIROPRACTIC
COLLEGE OF HEALTH SCIENCES

BRIDGES
A MOBILUS Library Catalog

MOBILUS Bridges Logan University My Library Account Help Course Reserves

Request Add to My Lists Add to Bag MARC Display Returns to Browse Modify Search More Like This Search MOBILUS

WORD ipad Logan Search

Limit search to available items

Did you mean pad? more +

5 results found. Sorted by relevance date title

Next Record

Title iPad Air charger and adapters [realia] / designed by Apple in California ; assembled in China.
Published Cupertino, Calif. : Apple, Inc., 2014.

Copies	LOCATION	CALL NO	STATUS
	Logan iPads	Charger #1	AVAILABLE
	Logan iPads	Charger #2 c.2	AVAILABLE
	Logan iPads	Charger #3 c.3	AVAILABLE
	Logan iPads	Charger #4 c.4	AVAILABLE
	Logan iPads	Charger #5 c.5	AVAILABLE

Text item location

Permanent Link - <http://bridges.searchmobius.org/record=b2280594-56>

Description 1 8-pin (2.3 ft.) lightning USB cable, 1 30-pin (4 ft.) lightning USB cable, 1 12W USB power adapter : white.
Note Adapter model A1401.
Subjects iPad (Computer)
Tablet computers.
Other Author Apple Computer, Inc.
Other Title Adapter.
Charger.

Concordia Seminary - Covenant Seminary - Fontbonne University - Harris-Stowe State University
Kearlck-Glannon Seminary - Lindenwood University - Logan University
Maryville University - Missouri Baptist University - Webster University - Eden Seminary

POLICIES & PROCEDURES

- Policies & Procedures
- Check-in Procedures
 - Unregister SofTest-M
 - Reset Guided Access Passcode
 - Clear Safari history & cookies
 - Close all open applications
- Promotion of iPads

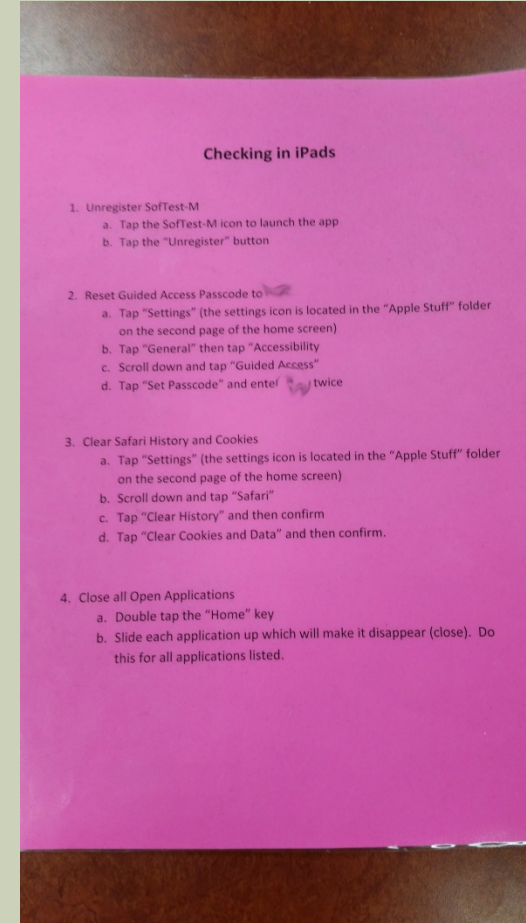

SETUP AND IMPLEMENTATION

Fontbonne
University

FLYING WITHOUT A NET

- Unlike Logan, whose IT Dept. managed their implementation, scrappy librarians implemented this small project.
- This is relatively new implementation and we are continually learning, discovering what works and what needs improvement.

DEVICE HISTORY

- Nooks and Kindles.
- Kindle Fires and Galaxy Tablets.
- Nexus tablets.
- More mindful this go around in both patron privacy and device management.

HOW / WHY DID WE ACQUIRE THE IPADS IN THE FIRST PLACE?

- Faculty member was awarded a grant using iPads in her research.
- After research was completed, 8 iPad Airs and 2 iPad Minis donated to the Taylor Library.

APPLE ID CREATION

- Fontbonne University already an Apple customer.
- IT Department required to create a sub Apple user account for the Library.
- Created a separate Apple Volume Purchase Program for Education (VPP) account.

HARDWARE REQUIREMENTS

- Mac desktop or notebook.
- USB port hub with charging.
- External hard drive to back up machine, if not networked.
- iPads.



SOFTWARE REQUIREMENTS



■ Apple Configurator Software



■ Time Machine

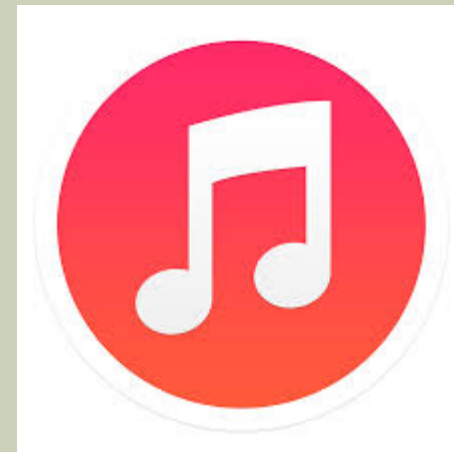

■ iTunes

ITUNES

- Download apps.
- Update apps. (More on updating apps later.)

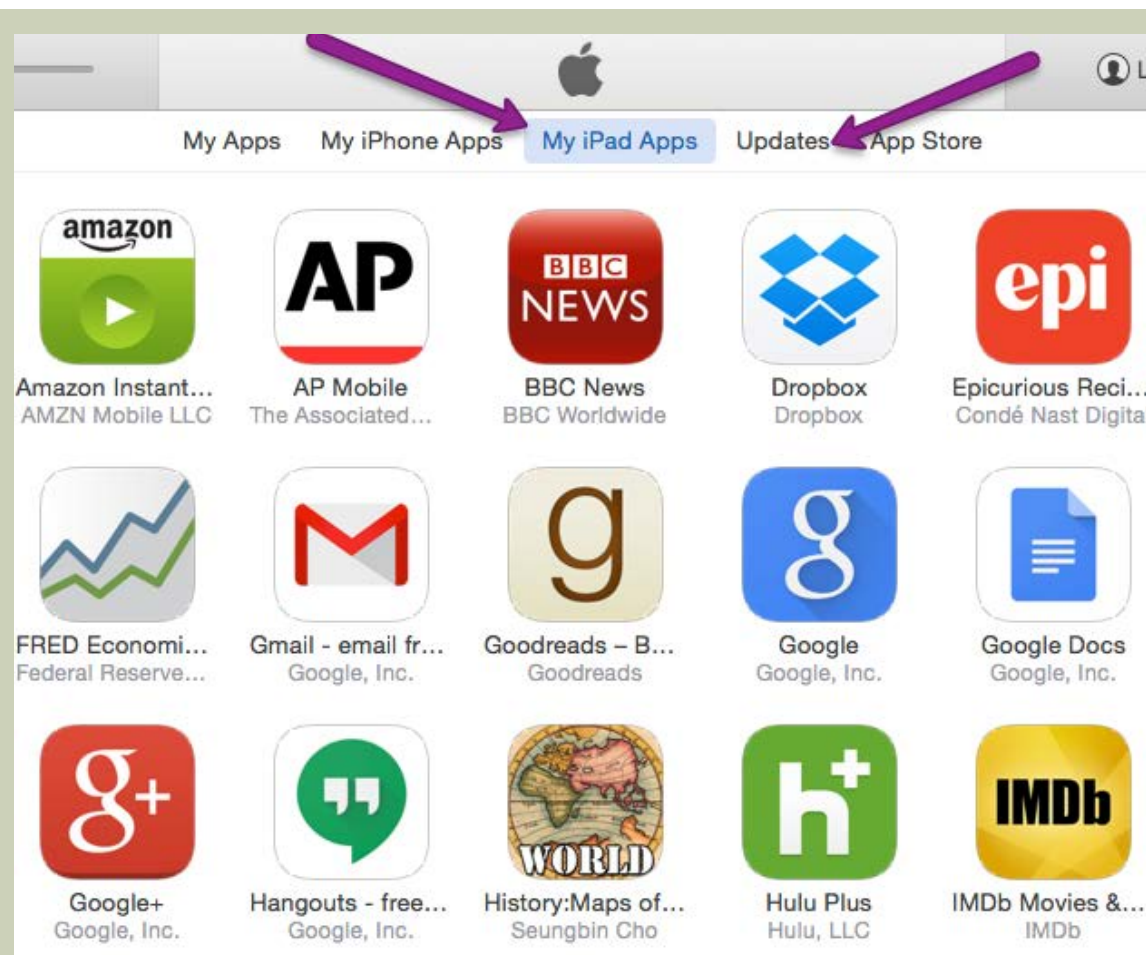

APPLE CONFIGURATOR

- In the App Store, download the Apple Configurator software to the Mac.
- Configurator only runs on a Mac.

Search Results for "apple configurator"



Apple Configurator

Utilities

★★★★☆ 11 Ratings

OPEN ▾

APPLE CONFIGURATOR

- Designed to manage iPads for classroom or enterprise use in large numbers.
- Creation of multiple user profiles for multiple requirements.
- Such as lending iPads to student users, instructors, and administrators.
- Taylor Library does not require many of Configurator's features.
- And, as a result, our usage of the software is limited.

CONFIGURATOR NOMENCLATURE

- Prepare
- Supervise
- Assign
- Settings
- Setup
- Restore
- Refresh
- Profile
- Check Out
- Configure

The screenshot displays the MDM Configurator interface with the 'Settings' tab selected. The top navigation bar includes 'Prepare', 'Supervise', and 'Assign' icons. Below this, the 'Settings' tab is active, with 'Apps' and 'Setup' tabs also visible. The main configuration area includes:

- Name:** Air_1
- Number sequentially starting at 1
- Supervision:** ON (toggle switch) and Organization Info... (button)
- Allow devices to connect to other Macs
- Update iOS:** When update is available (dropdown menu)
- Erase before installing
- Restore:** Air_Profile_02_2015 (dropdown menu)
- Profiles:** Library Patron (checkbox checked)

CONFIGURATOR PREPARE SETTINGS

- Turned on device Supervision.
- Disallowed devices to connect to other Macs.
- Update iOS.
- Restore from backup.

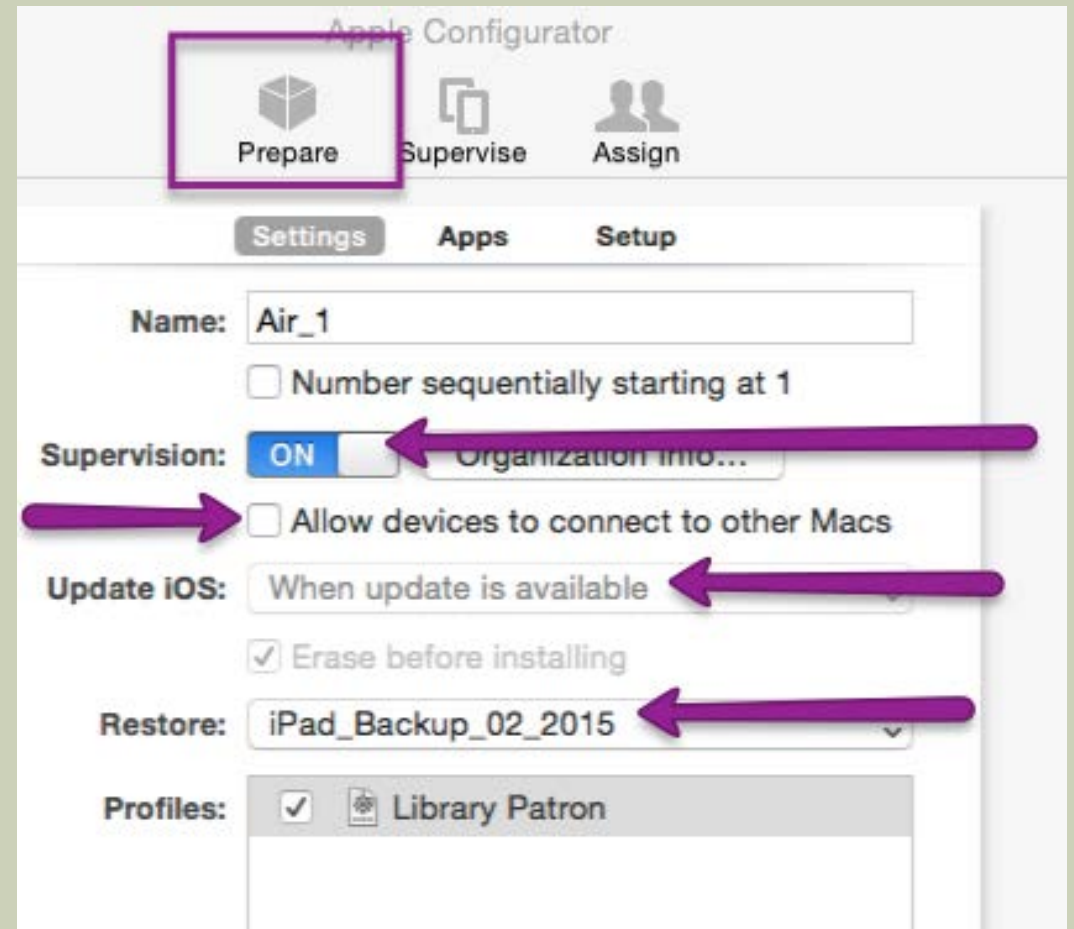

CONFIGURATOR PREPARE PROFILES

- General settings
 - Organization name
 - Wi-Fi
 - Web Clips

- Restrictions for device functionality.

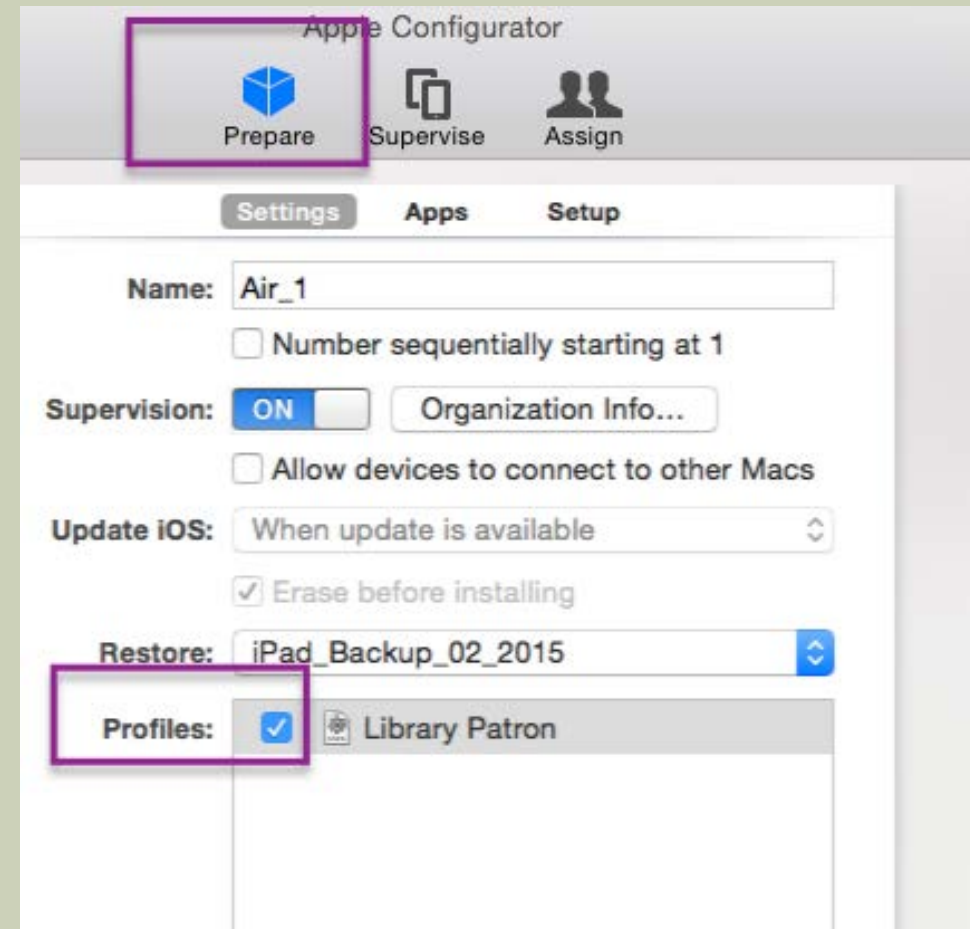

CONFIGURATOR PROFILES

- Profile restrictions can be used to :
 - Disable app downloads and/or in-app purchases.
 - Disable apps such as FaceTime and/or iTunes.
 - Disable the capability to change e-mail accounts, multiplayer gaming, media access.
 - Determine and set e-mail accounts, wireless network connections, passcodes, Safari preferences, user contacts and calendars.

CONFIGURATOR PROFILE RESTRICTIONS FUNCTIONALITY

- Limit functionality of specific device features for both the end user and the Supervisor.

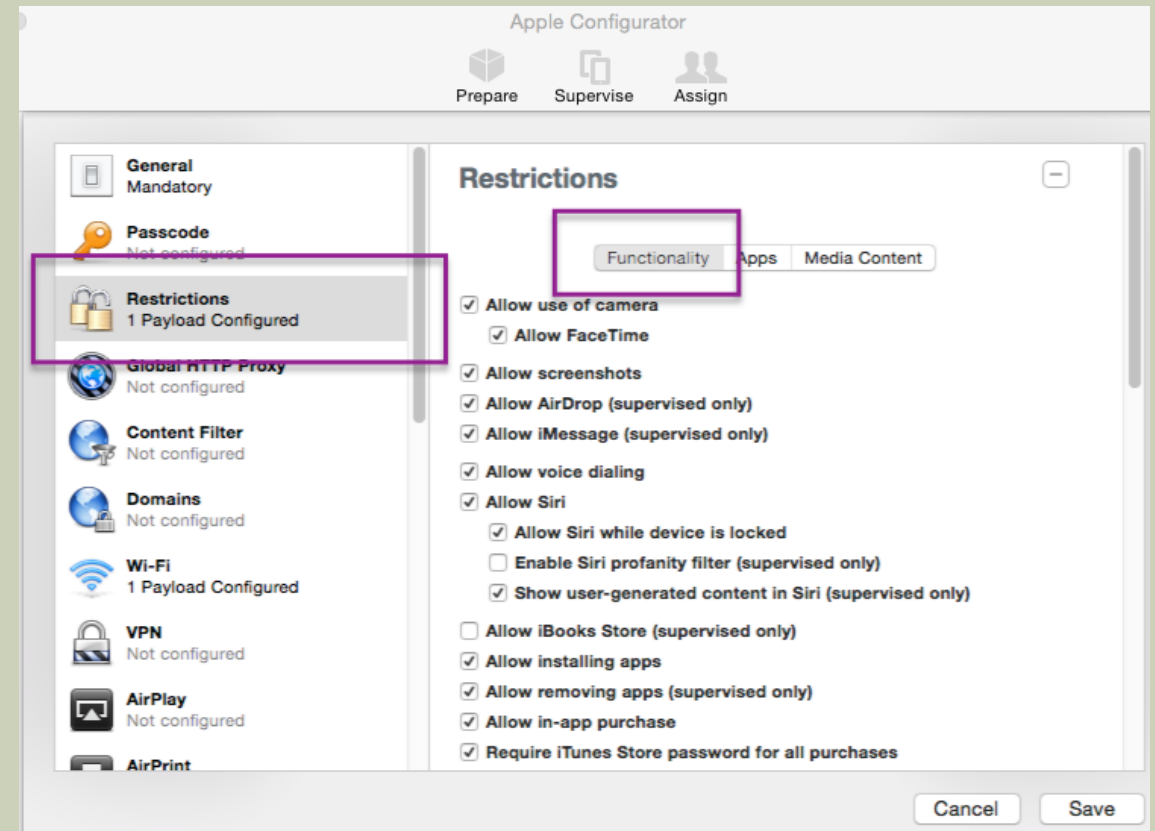

CONFIGURATOR PROFILE RESTRICTIONS APPS

- Limits the use of preinstalled Apps.

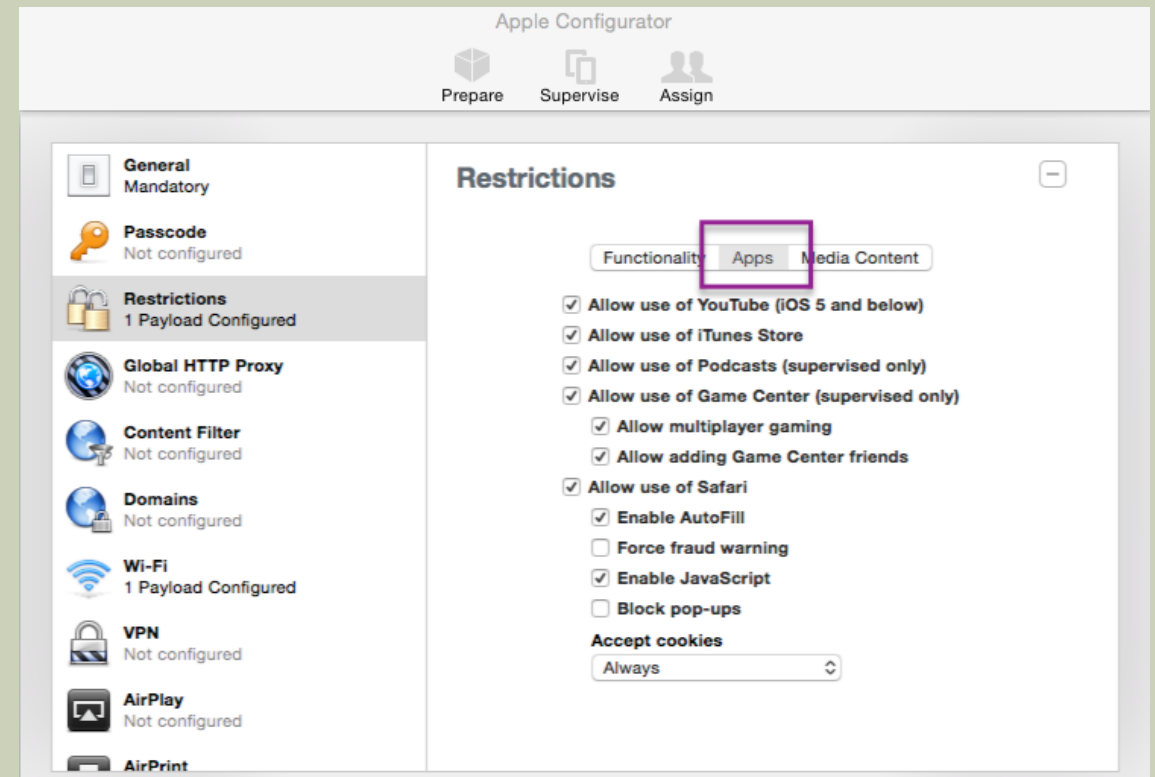

CONFIGURATOR PROFILE RESTRICTIONS MEDIA CONTENT

- Limits the use of media.

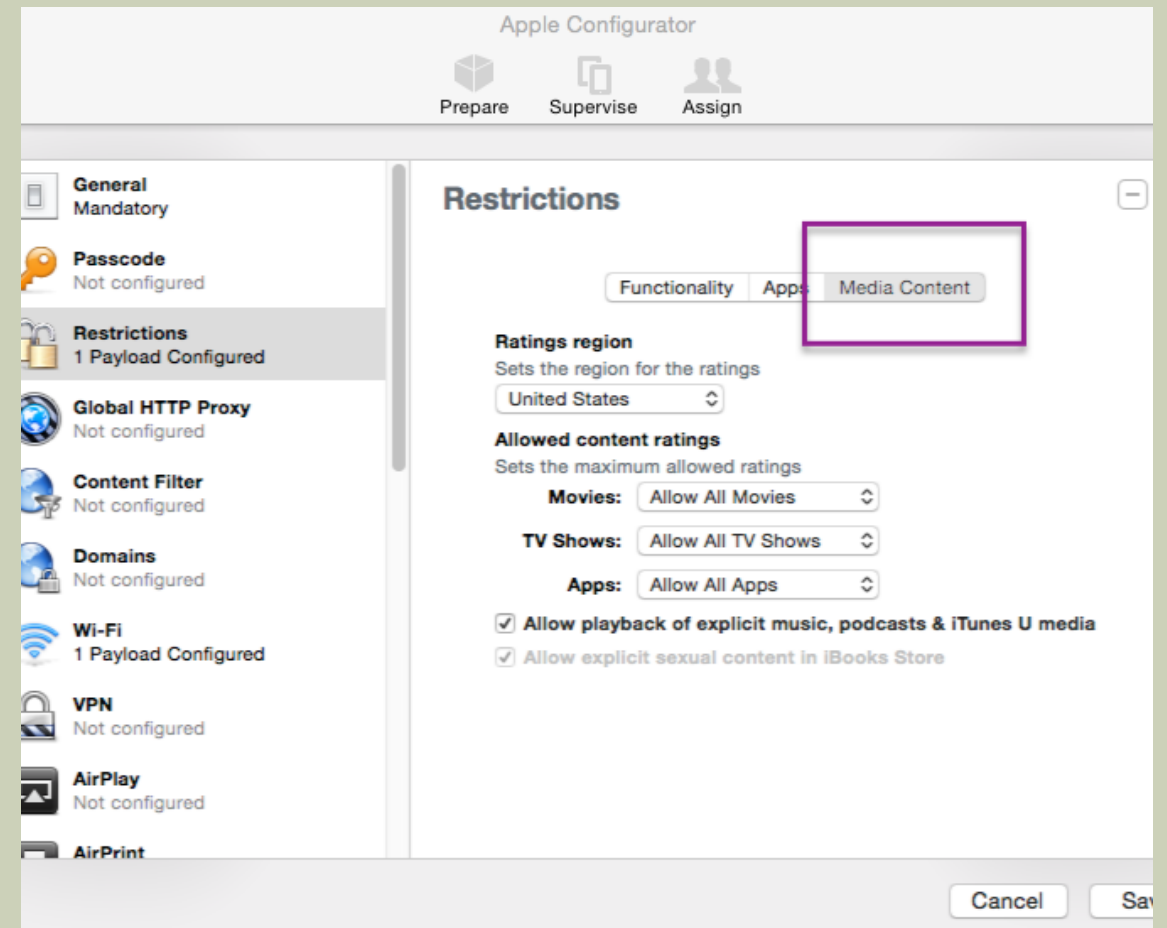

CONFIGURATOR PREPARE APPS

- Apps can be added or deleted from the Configurator software.
- Apps uploaded here from iTunes.

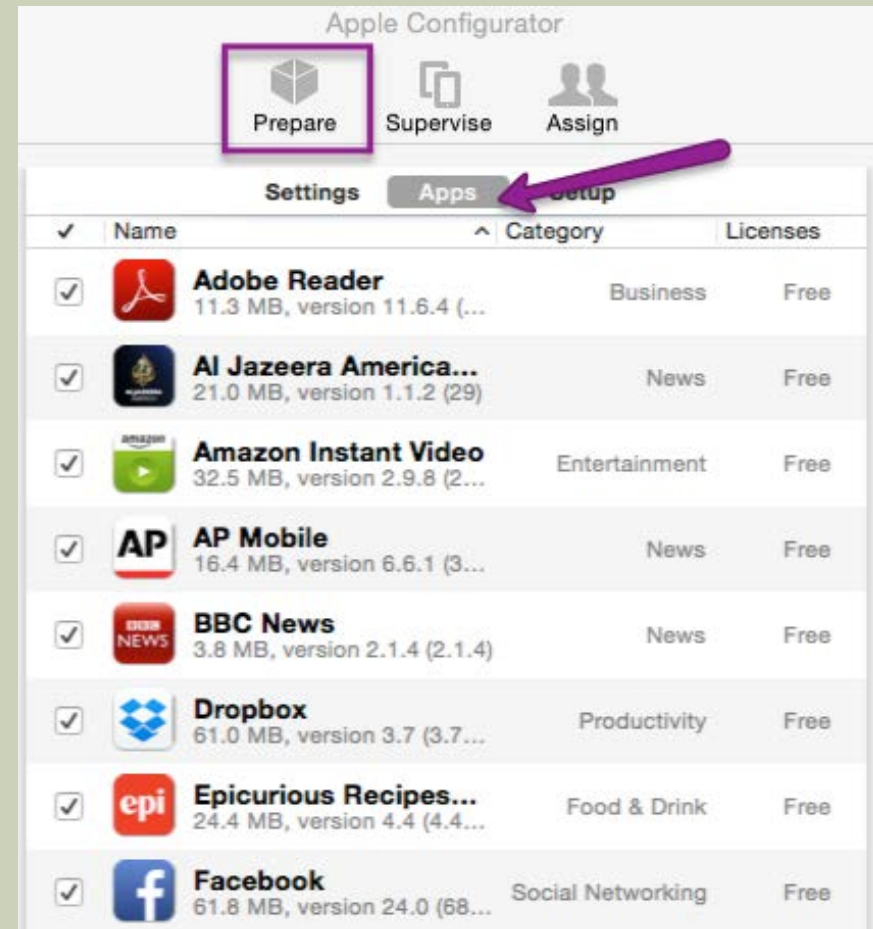

UPDATING APPS

iTunes

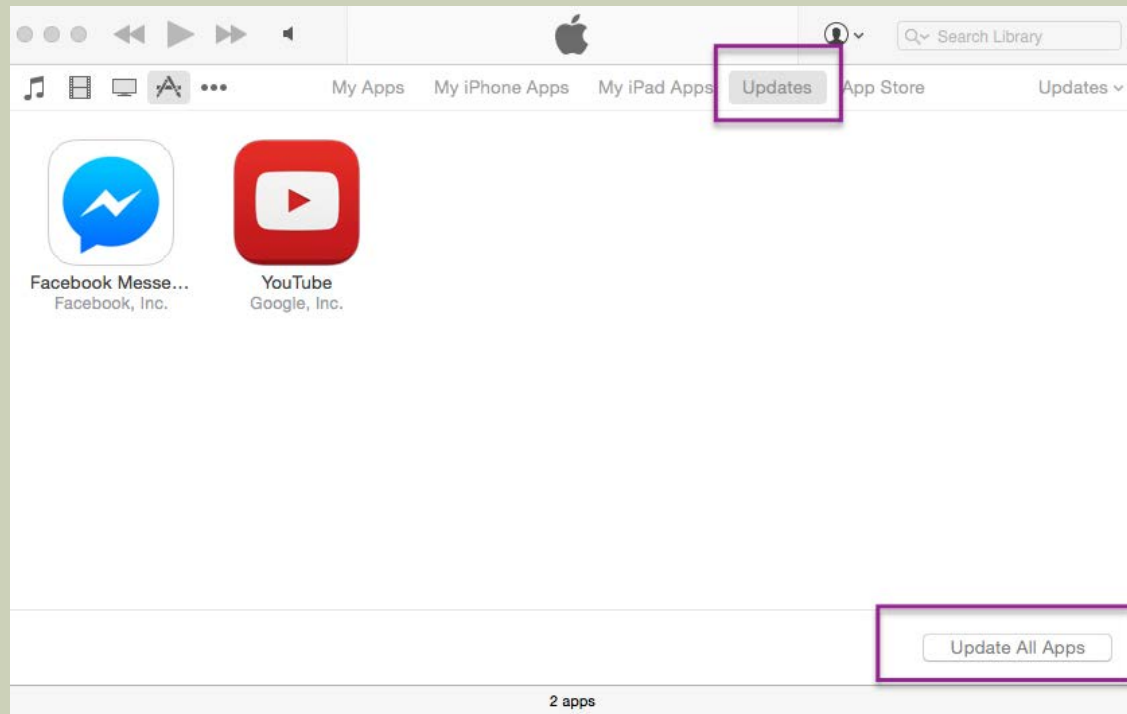

Apple Configurator

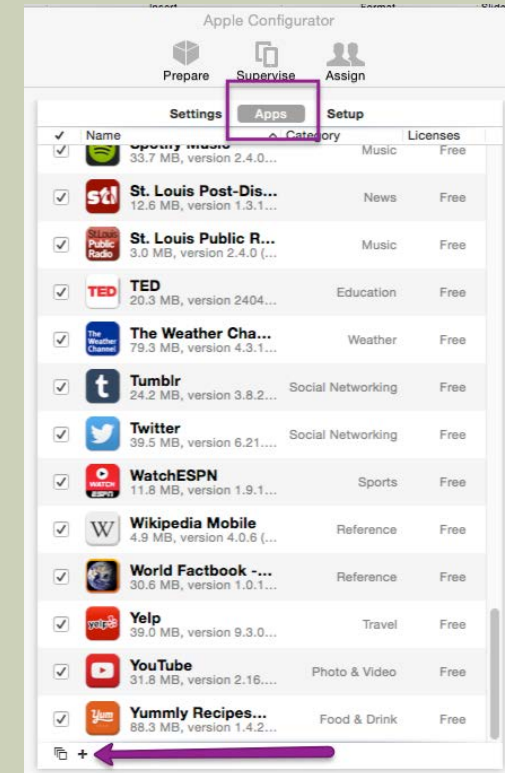

APPS LIVE IN ITUNES

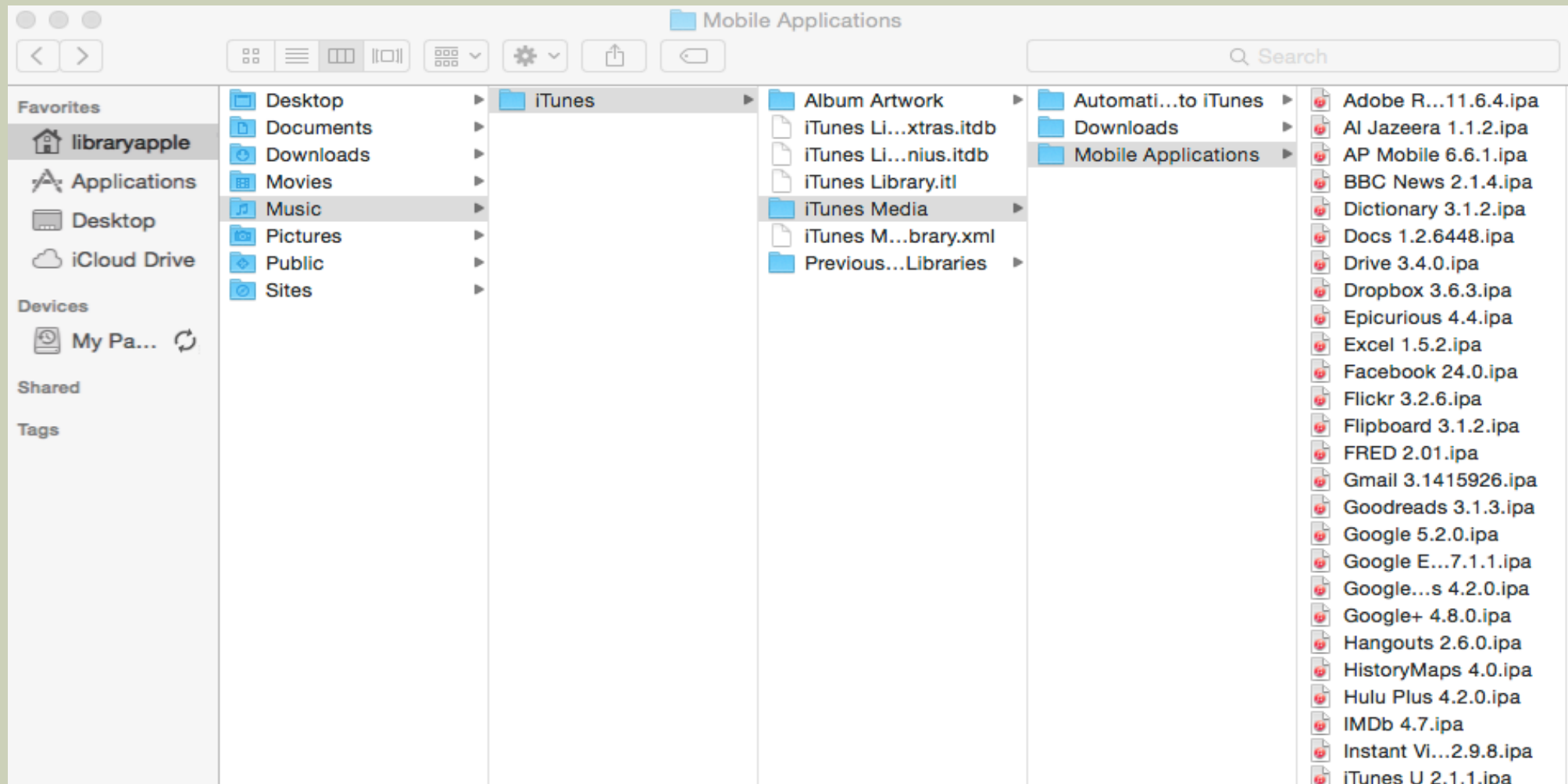

MASTER IPAD DEVICE

- Used Configurator settings and 1 iPad to create a master iPad template with the settings and apps we wanted to deploy.
- Backed up that iPad master file into the Configurator.
- Supervised this backup to “restore” the devices after patron use.

APPLE CONFIGURATOR SUPERVISE

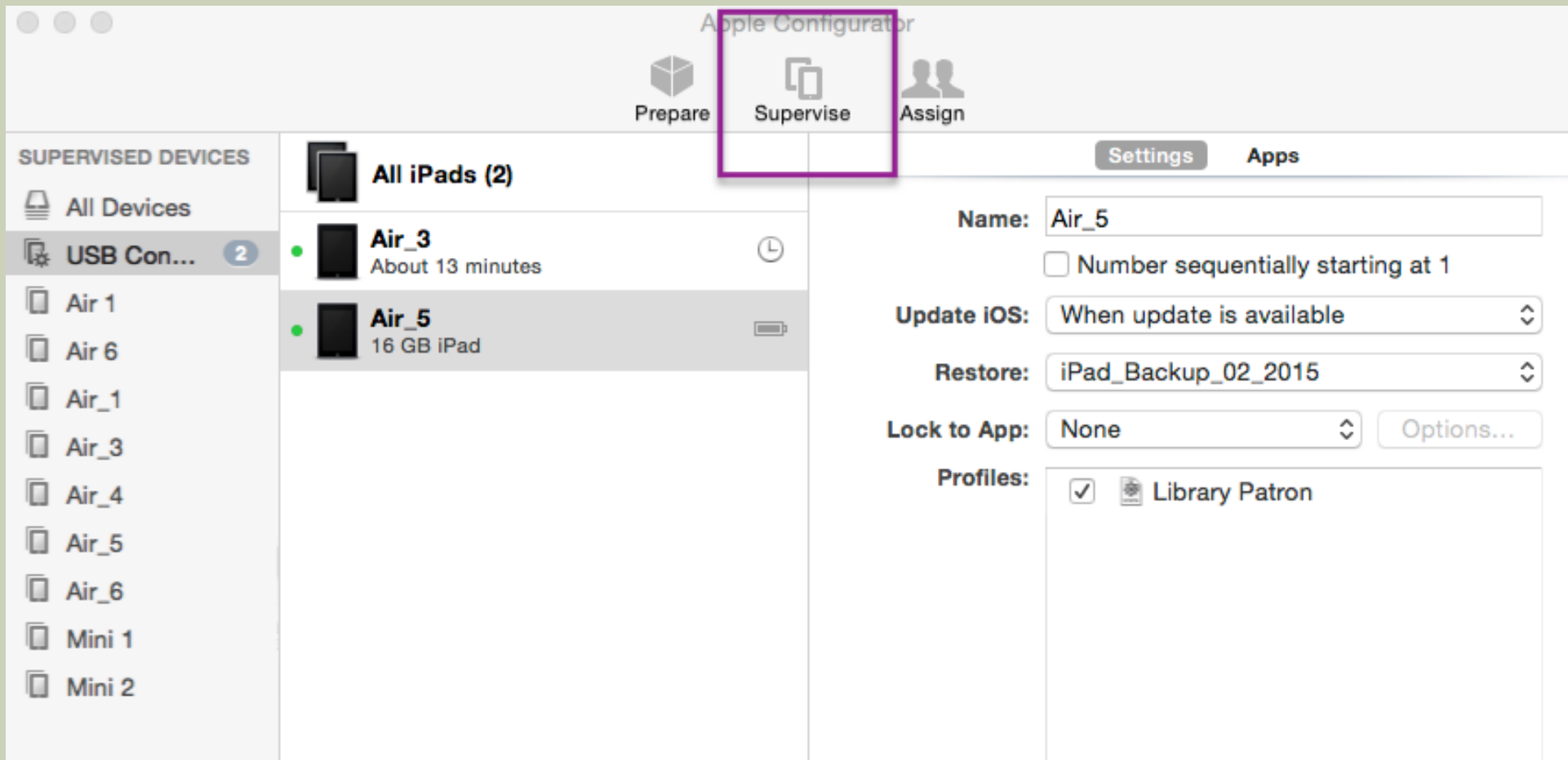

APPLE CONFIGURATOR SUPERVISE

The screenshot shows the Apple Configurator interface in the Supervise mode. The title bar reads "Apple Configurator". Below the title bar are three buttons: "Prepare", "Supervise" (highlighted with a purple box), and "Assign".

The main content area is divided into two panes. The left pane, titled "SUPERVISED DEVICES", contains a list of devices: "All Devices", "USB Con..." (with a '2' badge), "Air 1", "Air 6", "Air_1", "Air_3", "Air_4", "Air_5", "Air_6", "Mini 1", and "Mini 2".

The right pane shows the status of the selected device, "Air_3". At the top, it says "Devices are being updated." with a "Stop" button. Below this, the device name "Air_3" is shown with a 99% battery icon. A "Refresh" button is visible, with a sub-label "About 10 minutes".

The bottom section of the right pane lists the applications being installed or updated:

- Installing "History:Maps of World"
- Waiting to install "Google"
- Waiting to install "Merriam-Webster Dictionary HD"
- Waiting to install "Google Maps"
- Waiting to install "Adobe Reader"
- Waiting to install "Khan Academy: learn math, biology, chemi..."
- Waiting to install "BBC News"
- Waiting to install "Netflix"
- Waiting to install "Google Drive - free online storage from Google"
- Waiting to install "TED"
- Waiting to install "Flipboard: Your Social News Magazine"

ASSIGN IPADS

- Assign is optional.
- Allows an IT department to function as its own device library.
- Ability to assign devices to various class levels, instructors, etc.
- Fontbonne does not use.

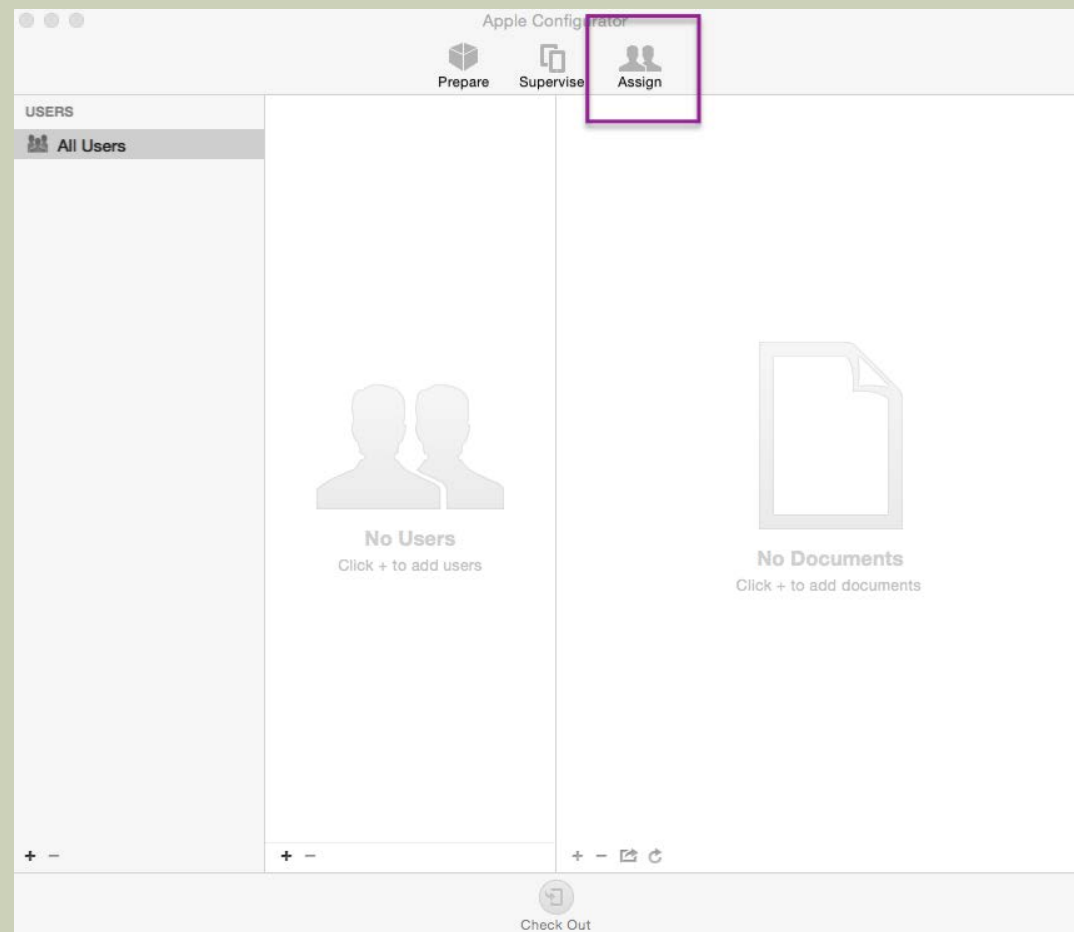

CONFIGURATOR MENU PREFERENCES

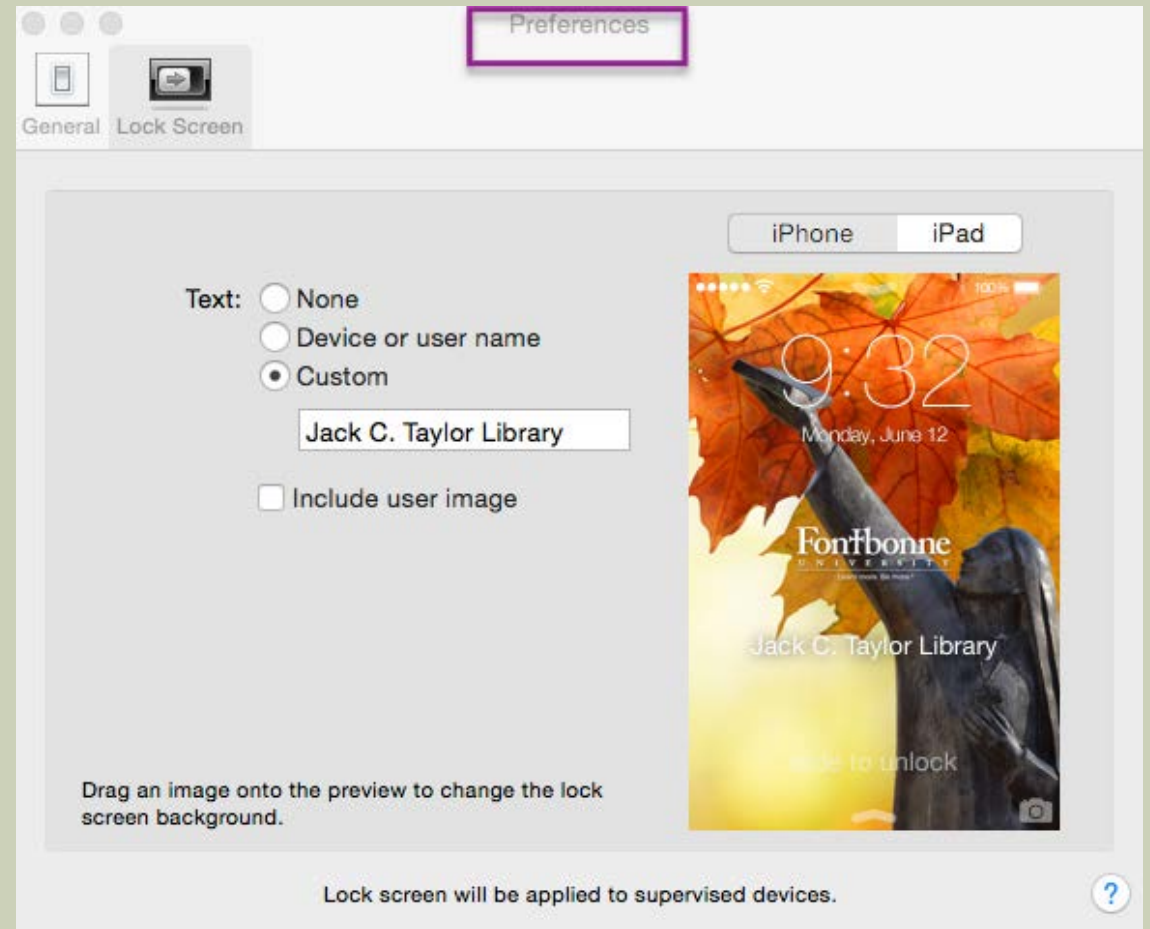
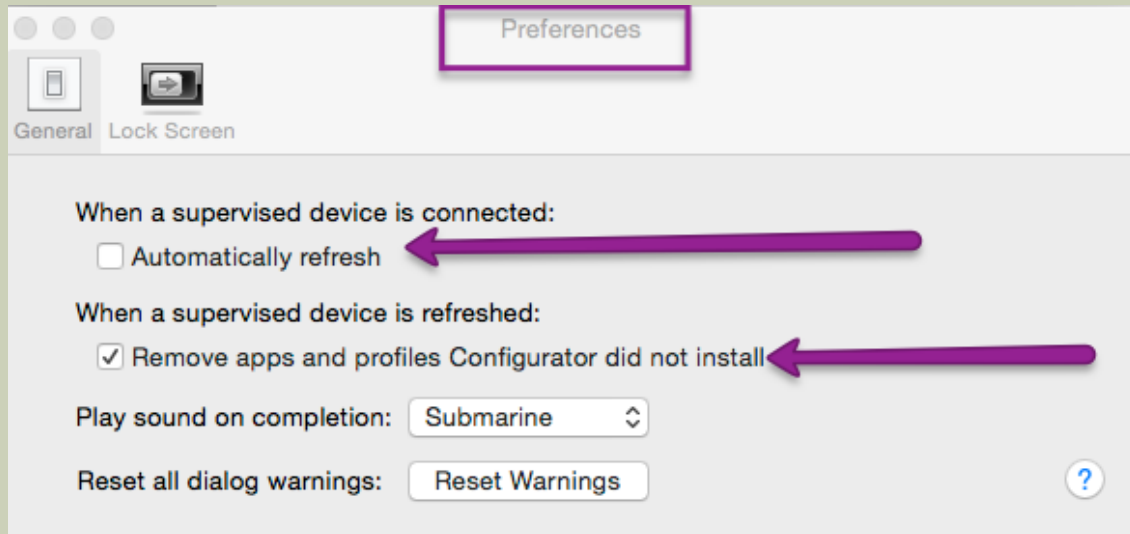

RESOURCES | APPLE REPRESENTATIVES

- Josie Lolli

HiED Account Executive | Apple Education

jlolli@apple.com

- Nathan Roy

Systems Engineer | Apple Education

nathanroy@apple.com

WEBSITES | BLOGS

- **Configuration Profile Key Reference**

<https://developer.apple.com/library/ios/featuredarticles/iPhoneConfigurationProfileRef/Introduction/Introduction.html>

- **Oh Apple Configurator, I will not be defeated!!**

<http://mgleeson.edublogs.org/2012/12/10/oh-apple-configurator-i-will-not-be-defeated/>

- **What I've learned about Apple Configurator... so far**

<https://edtechstandish.wordpress.com/what-ive-learned-about-apple-configurator-so-far/>

DEVELOPING A COMPREHENSIVE DEVICE MANAGEMENT POLICY

**Fontbonne
University**

OVERVIEW

- **Preparing to draft a policy**
- **Writing a policy**
- **Communicating a policy**
- **Getting Started (some possible resources)**

SOME POLICY EXAMPLES

- <http://library.newpaltz.edu/policies/ipadlending.html>
- <https://lbis.kenyon.edu/library-research/circulation/MacbooksandIPads/FAQ>
- <http://www.lib.vt.edu/artarch/ipad-policy.html>
- <http://zsr.wfu.edu/about/policies/ipad-usage/>
- <http://libguides.hgtc.edu/ipads>
- <https://library.lyndonstate.edu/about-the-library/ipad-loan-policy/>
- http://www.skylinecollege.edu/library/assets/documents/Tablet_Policy_Agreement.pdf

POSSIBLE CATEGORIES

- Eligibility
- Availability
- Loan Period
- Renewals/Returns
- Late Fees
- Liability
- Content
- Personal Data
- FAQ's
- Contact information

DOWN TO FOUR(ISH)

- Availability
- Renewals & Returns
- Fines & Damages
- Personal Data & Information

Jack C. Taylor Library

Did you know the library has tablets and e-readers available for checkout?

- HOME
- My Library Account
- Frequently Asked Questions
- Classic Catalog
- Digital Resources
- Journals A-Z
- Faculty Resources
- LibGuides
- Library Tutorials
- Research Help
- New Books
- New DVD's
- About Us
- INT199
- MOBIUS Catalog
- Interlibrary Loan: Article
- Tablets & E-Readers**
- University Archives
- The FONT (1926-1968)

@ the Library

Links to Fontbonne's Catalog:

- [Galaxy Tab3](#)
- [iPad Air](#)
- [iPad mini](#)
- [Kindle](#)
- [Kindle Fire](#)
- [Nook](#)
- [Nook Color](#)

Tablets & E-Readers: Check One Out Today!



Availability

As part of our [Mission](#) to provide resources that promote lifelong learning, the Library offers a variety of e-readers and Apple, Android, and Amazon tablets for two-week checkout. The devices are available first-come-first-served to all Fontbonne students, faculty, and staff in good standing. Current identification must be provided. Requests for specific units can be made through the [Catalog](#) or at the Circulation Desk; we will email your Fontbonne account when they become available.

Groups of devices also may be made available to faculty for classroom use. You can direct requests to Mark Glenshaw in Circulation: mglenshaw@fontbonne.edu / 314-719-8088. Please provide at least two weeks' notice and include any special requests.

Renewals & Returns

Renewals are not allowed at this time. Each tablet includes a USB cable, a power adapter, a cover, and a carrying case. For your protection, please return all pieces to the Circulation Desk in person to be checked in. There is a 24-hour turnaround time for all devices when they are returned.

Fines & Damages

Units and/or accessories not returned within three (3) business days of the due date will be billed to your Library account.

- Device: \$500

Available Apps

Don't see what you're looking for? Just ask your favorite Librarian or drop us an email: libraryhelp@fontbonne.edu.

- [Adobe Reader | iOS](#)
- [Al Jazeera America](#)
- [Amazon Instant Video](#)
- [App Store | iOS](#)
- [Associated Press Mobile](#)
- [BBC News Worldwide](#)
- [Blackboard Learn Mobile](#)
- [Dropbox](#)
- [Economic Research | Federal Reserve Bank of St. Louis](#)
- [Epicurious](#)
- [ESPN Score Center](#)
- [Facebook](#)
- [Facebook Messenger](#)
- [FaceTime | iOS](#)
- [Flickr](#)
- [Flipboard](#)
- [goodreads](#)
- [Google+](#)
- [Google Calendar](#)
- [Google Drive](#)
- [Google Earth](#)
- [Google Maps](#)
- [Google Hangouts](#)
- [Google Mail \(Gmail\)](#)
- [Google Search](#)
- [Google Translate](#)
- [History: Maps Series](#)
- [Hulu PLUS](#)
- [iCloud | iOS](#)
- [IMDb Mobile](#)

POLICY PAGE

Request
 Add to My Lists
 Add to Bag
 MARC Display
 Search MOBIUS

RECORD NO Fontbonne Search

Limit search to available items

Title iPad Air [realia] / designed by Apple in California ; assembled in China.
Published Cupertino, Calif. : Apple, Inc., 2013.



3-D Object

Connect to
Fontbonne Tablet Policy

Copies

LOCATION	CALL NO	STATUS
Fontbonne Univ Circulation Desk	iPad Air 01 ---	DUE 02-11-15
Fontbonne Univ Circulation Desk	iPad Air 02 ---	AVAILABLE
Fontbonne Univ Circulation Desk	iPad Air 03 ---	AVAILABLE
Fontbonne Univ Circulation Desk	iPad Air 04 ---	AVAILABLE
Fontbonne Univ Circulation Desk	iPad Air 05 ---	AVAILABLE
Fontbonne Univ Circulation Desk	iPad Air 06 ---	AVAILABLE
Fontbonne Univ Circulation Desk	iPad Air 07 ---	AVAILABLE
Fontbonne Univ Circulation Desk	iPad Air 08 ---	DUE 03-02-15



Text item location

Permanent Link - <http://bridges.searchmobius.org:80/record=b2280594~S2>

Description 1 tablet computer : black, sd., col. screen ; 24 x 17 x 1 cm. + lightning to USB cable (3-ft.) + 12W USB power adapter.

Note Model MD785LL/A ; adapter Model A1401; other Model no. A1474.
Supports Wi-Fi and Bluetooth.

Subjects **iPad (Computer)**
Tablet computers.

Other Author **Apple Computer, Inc.**

Other Title Apple iPad Air.

OCLC # 862223687

Search Options

- Advanced Search
- Author
- Title
- Journals, Magazines, Newspapers
- Numbers
- Subject (LC)
- Children's Subject
- Medical Subject
- Series Title
- Author and Title
- Genre
- Featured Lists

Catalog Record Detail

Jack C. Taylor Library

Welcome to YOUR Jack C. Taylor Library!

- HOME
- My Library Account
- Frequently Asked Questions ▾
 - Alumni & Emeritus Policies
 - Conduct Policies
 - Guest Policies
 - Policies & Procedures: Students
 - Policies & Procedures: Faculty
 - Policies & Procedures: Staff
 - Tablets & E-Readers
- Library Tutorials
- Research Help
- New Books
- New DVD's
- About Us ▾
- INT199 ▾
- MOBIUS Catalog
- Interlibrary Loan: Article ▾
- Tablets & E-Readers**
- University Archives ▾
- The FONT (1926-1968) ▾



Search the Library Collections

Discovery | Classic Catalog | Digital Resources | Subject Guides

Searching: Discovery Search

Use the Library's Discovery Search to find books, articles, images, and statistics – All at one time! You can use the 'Advanced Search' tool to limit your results.

Keyword Title Author

[Basic Search](#) | [Advanced Search](#)

New @ the Library

New LibGuide available to you!
Ferguson: Contexts & Consequences (<http://library.fontbonne.edu/ferguson>)

LIBRARY HOURS

Regular Hours:
 Mon.-Thurs. - 7:30 a.m. - 11 p.m.
 Friday - 7:30 a.m. - 5 p.m.
 Saturday - 9 a.m. - 5 p.m.
 Sunday - 1 p.m. - 9 p.m.

« February 2015 »

S	M	T	W	T	F	S
1	2	3	4	5	6	7
8	9	10	11	12	13	14
15	16	17	18	19	20	21
22	23	24	25	26	27	28

Upcoming Events:
 Fri, Apr 3, 2015 All Day
Library CLOSED
 Sat, Apr 4, 2015 All Day
Library CLOSED
 Sun, Apr 5, 2015 All Day
Library CLOSED
 Mon, Apr 6, 2015 All Day
[Show All](#)

Contact Us!

314-889-1417

314-719-8040

[EMAIL US!](mailto:LibraryHelp@fontbonne.edu)

LibraryHelp@fontbonne.edu

Follow

Featured Resource

Studying Religion?



<http://library.fontbonne.edu>

- The Jack C. Taylor Library has added 8 iPad Airls and 2 iPad minis to its collection of e-book readers and tablets. To learn about the policies and available apps, go to Tablets and E-Readers found on the Library webpage.

- Please check out the iPads, try them, and let us know how we can improve this service!

Promoting
the
Collection

POLICY & PROGRAM RESOURCES

Brook, J., & Salter, A. A. (2012). E-books and the use of e-book readers in academic libraries: Results of an online survey. *Georgia Library Quarterly*, 49(4), 16-31.

Capdarest-Arest, N. A. (2013). Implementing a tablet circulation program on a shoestring. *Journal of the Medical Library Association*, 101(3), 220-224.

Gillum, S., & Chiplock, A. (2014). How to build successful iPad programs in health sciences libraries: A tale of two libraries. *Journal of Electronic Resources in Medical Libraries*, 11(1), 29-38.

Le Ber, J. M., Lombardo, N. T., Honisett, A., Jones, P. S., & Weber, A. (2013). Assessing user preferences for e-reader and tablets. *Medical Reference Services Quarterly*, 32(1), 1-11.

Oliver. (2010, October 14). iPad lending project: First results. [Web Log Post] *Journal of the European Association for Health Information and Libraries*.

Thompson, S. Q. (2011). Setting up a library iPad program: Guidelines for success. *College & Research Libraries News*, 72(4), 212-236.

QUESTIONS?

**Thank
you.**